

**FURNITURE GENERAL NOTES**

- 1 ALL FURNITURE INDICATED BY SYMBOL IS PROVIDED, DELIVERED AND INSTALLED BY FURNITURE CONTRACTOR.
- 2 REFER TO PROJECT MANUAL FOR FURNITURE INFORMATION AND QUANTITIES.
- 3 METAL SHELVING SHOWN IS DETAILED ON A10.01

**FURNITURE PLAN LEGEND**

- FURNITURE
- EXISTING FURNITURE TO BE REUSED
- FURNITURE BY OTHERS
- C# INDICATES FURNITURE LIST ITEM FOR THIS DRAWING ONLY. FURNITURE FOR REFERENCE ONLY AND NOT IN CONTRACT.
- FLOOR BOX LOCATION
- POWER/DATA STUB LOCATION

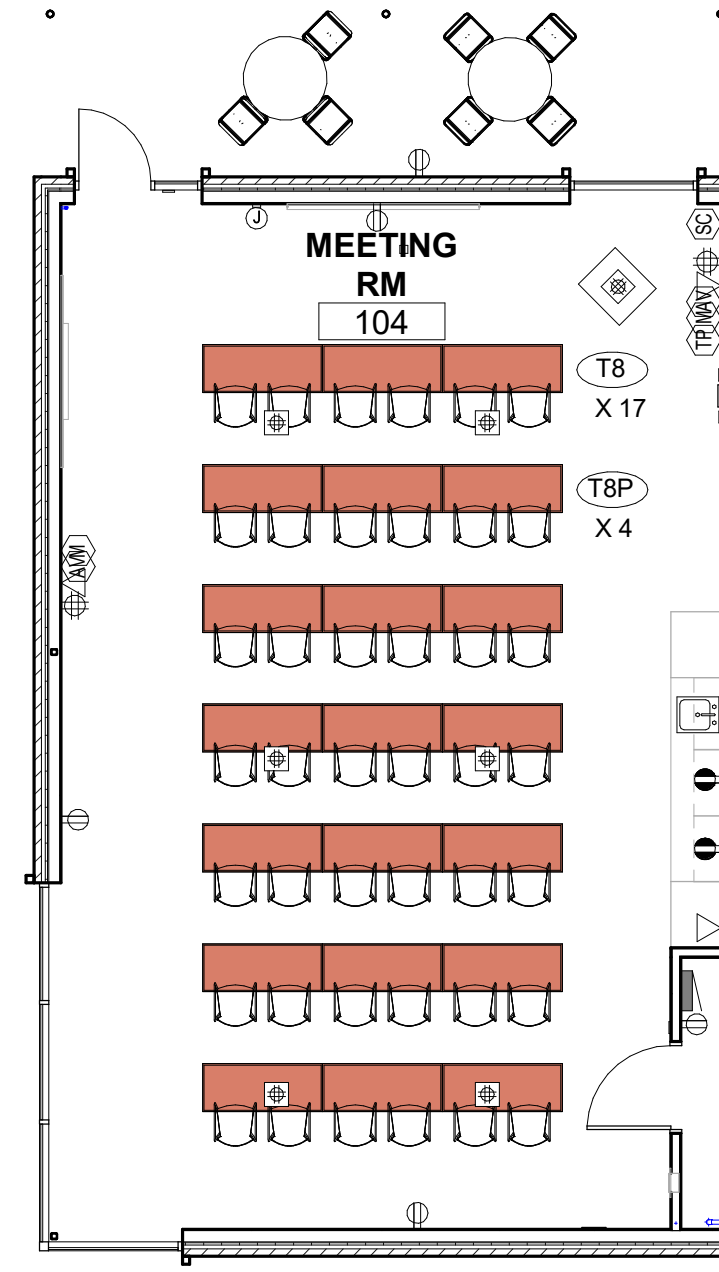

2 MEETING ROOM TABLE LAYOUT  
F1.00 1/8" = 1'-0"

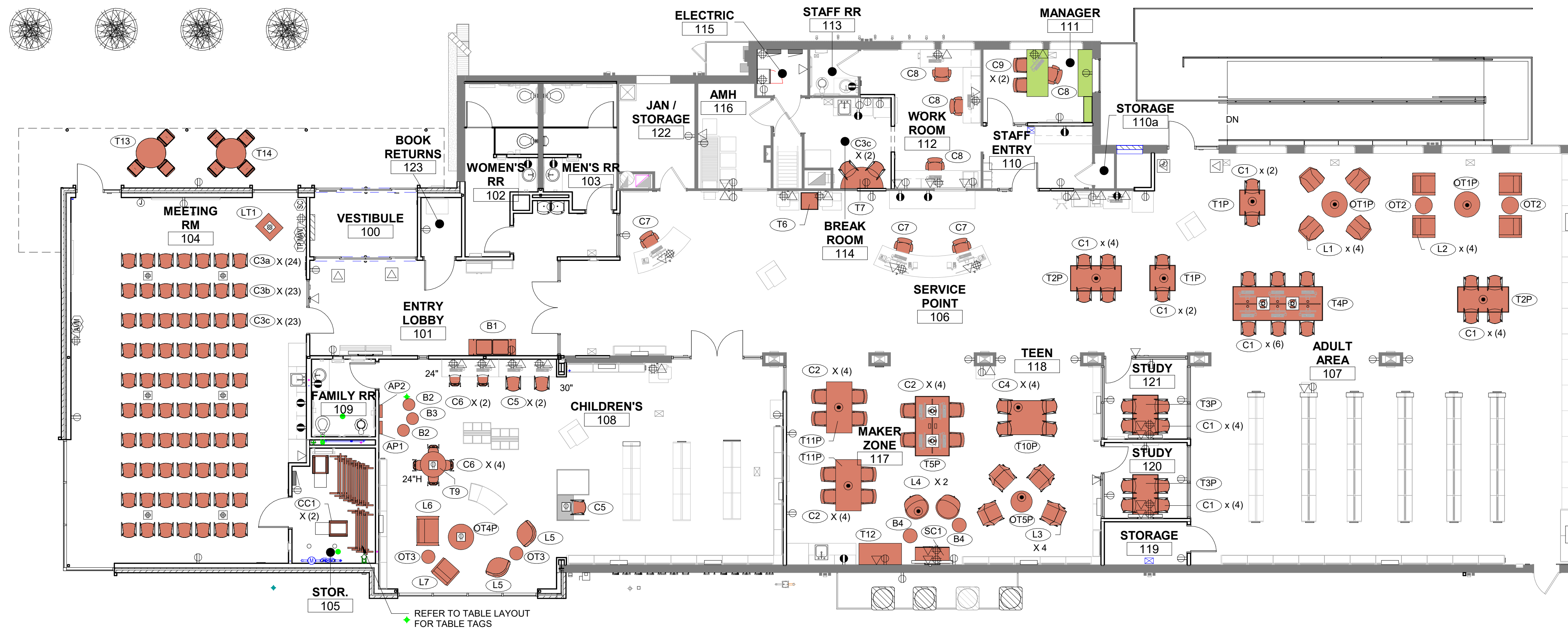

1 LEVEL 1 - FURNITURE PLAN  
F1.00 1/8" = 1'-0"

RENOVATION AND ADDITION TO  
 PUEBLO CITY-COUNTY LIBRARY DISTRICT  
**BARKMAN BRANCH**  
 1300 JERRY MURPHY ROAD  
 PUEBLO, CO 81001

DATE:  
06-26-2023  
PROJECT NO:  
22010  
SCALE:  
1/8" = 1'-0"

LEVEL 1 -  
FURNITURE  
PLAN

**F1.00**

NOT FOR CONSTRUCTION

216.241.1100  
 1382 West Ninth Street  
 Suite 300  
 Cleveland, Ohio 44113  
 www.HBMArchitects.com

#	DESCRIPTION	DATE
	FURNITURE PACKAGE	02.22.2024
	BID	