

RFP # 2-2024 - Category 2 Internal Network Connections Questions & Answers

- What Palo Alto subscriptions are needed specifically?

- The Primary License to use the firewall
- Support for the firewall

- Can the switches be power-stacked together?

- Negative

- To confirm, does each switch need to have its own SFP link?

- Correct

- Please provide a map of where the 5 access points are going to be installed.

- The below is the layout location of Giodone and respective locations are defined with: 

Library at the Y does not have a diagram but has one Wap less than 300ft away from the IDF that will need both the Cat 6 run and the new WAP as replacement.

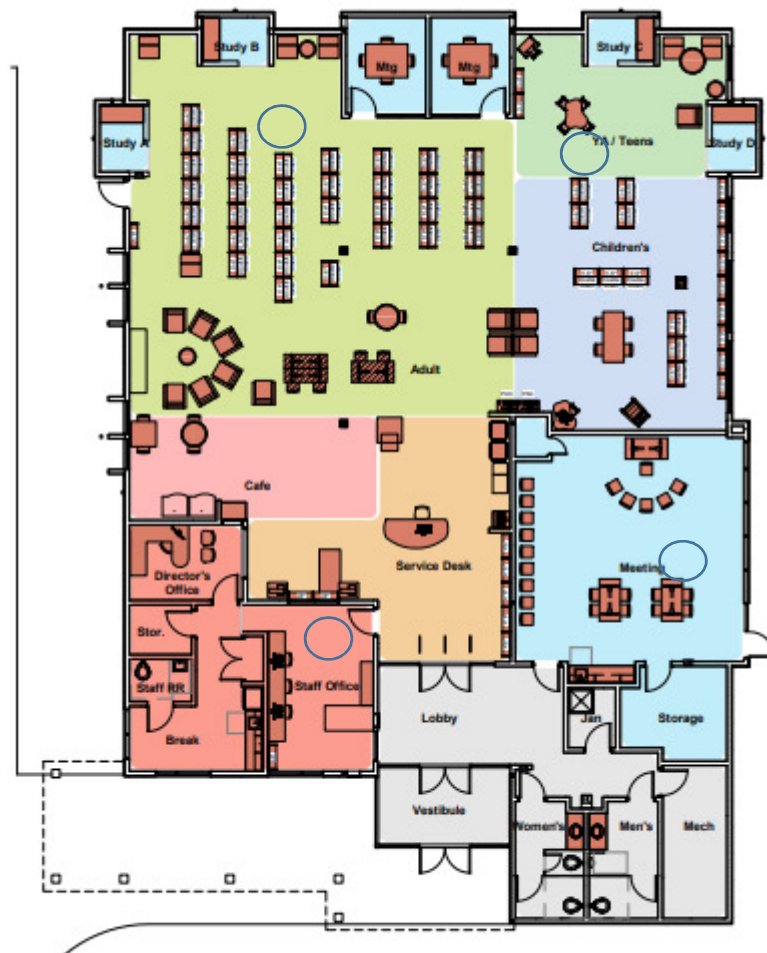

EXISTING FLOOR PLAN

Locations:

- Are the in-scope quantities listed in section 8 spread among all 3 locations or is it implied these will be for each individual location?
 - 4 WAPs will be for Giodone Library and one for the Library at the Y. Two Aruba 6300M switches will be for Giodone, one for the Library at the Y, and the rest for Rawlings Library. One UPS for Library at the Y, one UPS for Giodone, and the rest for Rawlings. 5 Category 6/6a drops will be for WAPS for Libraries Giodone and Library at the Y. The Y receiving 1 drop and the rest for Giodone.
- Has a wireless survey (passive or predictive) been performed at each location to determine access point placement?
 - If no, can floorplans be provided?
 - We are working to attain floor plans for these locations but may not be available for the Library at the YMCA as the building is not owned by PCCLD.
- What is the existing ceiling (drop ceiling, drywall, etc.) where the access points are to be mounted?

- Drop Ceiling
- Are there any aesthetics requirements that must be considered with regard to mounting solutions that could impact hardware purchases?
 - No
- Are all access points placed within 100m (330ft) of its respective MDF/IDF or Access Switch?
 - Yes

Installation:

- Are there coloring scheme requirements for any infrastructure cabling being installed? If so, what is that requirement?
 - No coloring scheme requirements are present
- Will all access point locations be accessible by ladder or is there a need for a lift? If a lift is needed, what is the ceiling height?
 - A lift is not required
- Section 8.5
 - Are these 5x drops for the access points to be installed or are they in addition to what would be required for the access points?
 - They are for the access points to be installed.

MDF/IDF:

- Are there existing patch panels/positions available for terminating any new infrastructure cabling or will this need to be provided?
 - There are existing patch panels, if for any reason they are filled up then PCCLD will attain a patch panel.
- Are there existing rack elevations available to show current state of the equipment?
 - Yes.
- Will a new rack be necessary to install any new equipment?
 - No.
- Will any devices need to be decommissioned prior to installing any new equipment?
 - Yes, old WAPS only.
- Can installation/Decomm tasks be completed during normal business hours or will afterhours time be needed?
 - Only during normal business hours of operation.
- Is there appropriate power in place to accommodate the UPS's? (Voltage, Receptacle type, current load and physical space)
 - Yes.