

RFP # 12-2023 – Security Camera System for Barkman Library Questions & Answers

- Per the addendum, are you planning on running conduit to the poles for the cameras or would you like us to quote a wireless solution?
 - Conduit routing was chosen with an eye towards keeping the cameras within reach of a CAT6 cable to eliminate the expense of fiber or CAT6 extenders to the cameras. Below is the diagram of the run that will be made.

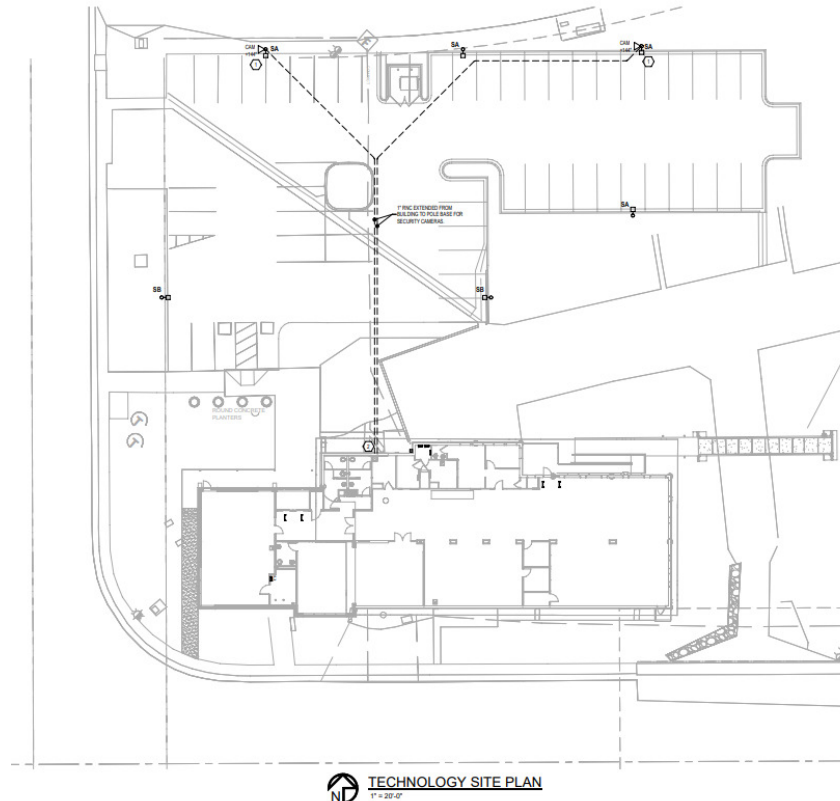

- What type of camera is required for the poles in the parking lot?
 - PoE++ CD62-E
- There was a pre-design of locations where PCCLD staff had suggested camera placement, is this available?
 - Yes it is below, note that camera E was a location that already had a Verkada camera that was removed. This was conducted by Flair Data before the remodel began and will be re-added to the front of the bathrooms by Flair Data to include the Verkada bathroom sensors that were removed. A drop must be included in the proposal for the camera and a drop per bathroom for the Verkada sensors, however quoting of the camera and sensors is not necessary. Please also note that the below is not a mandatory location of cameras but was an idea PCCLD prefers that location be suggested by the vendor.

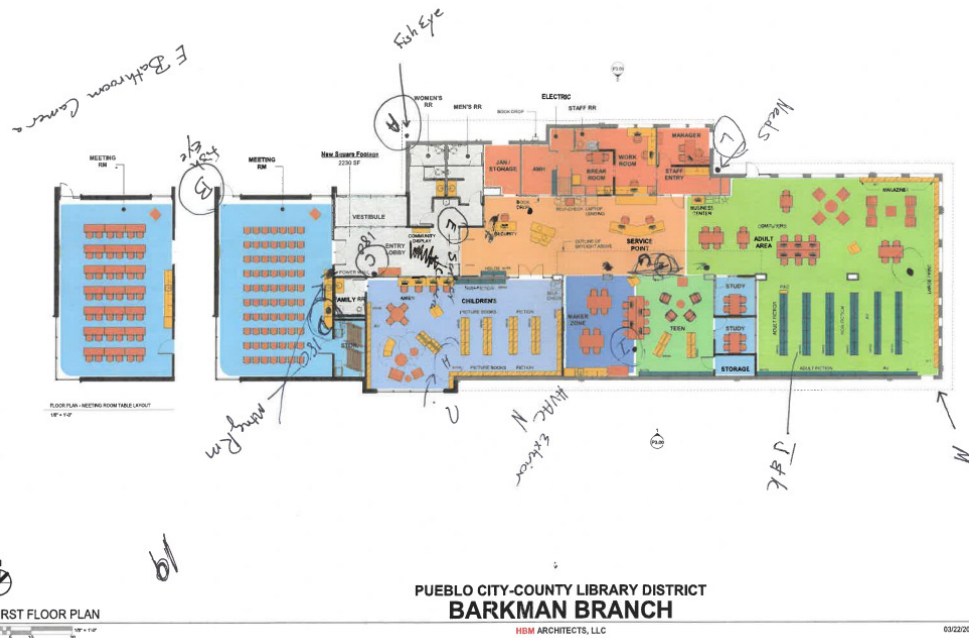

-
- Will PCCLD be providing the switch?
 - Yes PCCLD will be providing the network switch these cameras will be connecting too.